

Peter Kwasny GmbH, Heilbronner Str. 96  
74831 Gundelsheim / Deutschland  
Telefon: +496269 95-0, Fax: +496269 95-80  
www.spraymax.com / www.kwasny.com / info@kwasny.de

**SprayMax®**  
**Marine 2K PUR top coat black**  
**400 ml**  
**Art. Nr. 688015**



## Product

### Description / Purpose

High-quality 2K Pur top coat for maritime applications specially designed to protect areas above the water line against scratches, salt and UV light.

### Material base

Two-component polyurethane (Diol)  
Activator: aromatic isocyanates

### Colour

Black

### Gloss level

high gloss

### VOC Value (EU)

636 g/l

## Substrate

Iron primed with Spraymax Marine 2K Epoxy anti-corrosion primer and with Spraymax Marine 2K Epoxy primer filler  
Steel primed with Spraymax Marine 2K Epoxy anti-corrosion primer and with Spraymax Marine 2K Epoxy primer filler  
Cast iron primed with Spraymax Marine 2K Epoxy anti-corrosion primer and with Spraymax Marine 2K Epoxy primer filler  
Zinc/galvanised steel primed with Spraymax Marine 2K Epoxy anti-corrosion primer and with Spraymax Marine 2K Epoxy primer filler

Aluminium primed with Spraymax Marine 2K Epoxy anti-corrosion primer and with Spraymax Marine 2K Epoxy primer filler  
 Non-ferrous metals primed with Spraymax Marine 2K Epoxy anti-corrosion primer  
 Plastics primed with Spraymax Marine 2K Epoxy primer filler  
 Polyester surfaces primed with Spraymax Marine 2K Epoxy primer filler  
 Old paint and factory paint (cleaned and sanded) or primed with Spraymax Marine 2K Epoxy anti-corrosion primer and with Spraymax Marine 2K Epoxy primer filler  
 Wood / MDF / hard fibre boards (cleaned, sanded) and pretreated with appropriate products

The damaged area must be dry and free of grease and dust and all rust needs to be removed.

## Processing

### Protection measures



Wear personal protection equipment. (respiratory mask/gloves/goggles)  
 For more information, see safety data sheet.

### Shake

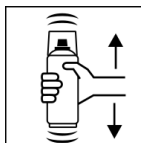

Before activating, shake can thoroughly for 2 minutes from when the mixing balls are heard.

### Place red button

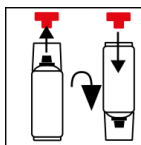

Remove the red button from the cap. Turn the can by 180° and fit the button onto the pin.

### Press red button

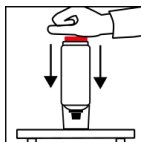

Turn the can upside down and place on a firm surface. Press the red button with the palm of your hand until it clicks into place.

### Shake

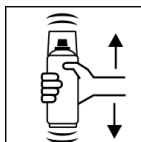

After activating, shake can again thoroughly for 2 minutes, again from when the mixing balls are heard.

**Spray to test**

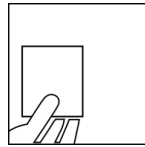

After shaking the can, test spray and check compatibility with the surface and the colour.

**Spraying distance**

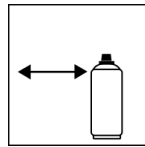

10 cm - 20 cm

**Spray passes**

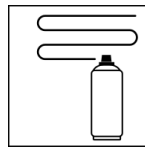

Dry film thickness 80 - 120  $\mu\text{m}$   
(approx. 2 - 3 spray coats)

**Flash-off time**

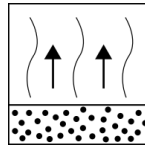

Flash time: approx. 10 - 15 min between each spray coat.

**Processing conditions**



Optimum application at 18° C - 25° C and a relative humidity from 40 - 60 %.

**Coverage**

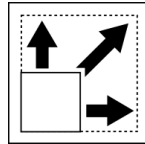

approx. 0,3 m<sup>2</sup> at 75  $\mu\text{m}$  dry film thickness

**Drying**

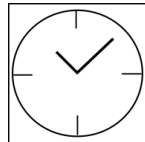

TG1 dust dry: 1.5 h

TG3 dry to touch: 6 - 8 h

TG5 ready for assembling: 24h (can be polished), completely hardened after 7 days.

The stated values refer to the above mentioned processing conditions. The level of dryness is determined pursuant to DIN 53150.

**Continue**

Polish (coarse und fine polish) dust inclusion/daisy disks with P1000 - 4000

**Pot life**

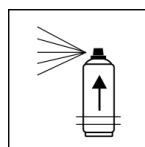

Approx. 8 h at 20 °C room temperature and a relative humidity of approx. 40 - 50 %. The processing time depends on the ambient temperature. Higher temperatures reduce the pot life, lower temperatures will prolong it. Min processing temp 15°C, max. 35°C

## Finish

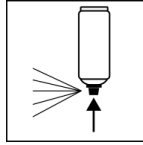

After painting, turn the can upside down and spray the valve until empty.

## Additional Information

### Important Information

Water load should only be allowed after approx. 7 days.

### Shelf Life

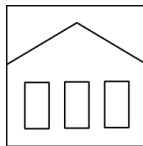

36 months (not activated)

The usage period refers to an unused can that is stored correctly at a temperature of 15 - 25° C and a relative humidity below 60%. The can must be stored and transported in an upright position in a dry place where it is protected against chemical and mechanical influences. The safety information on the can and all statutory provisions applicable for the storage site must be observed.

### Disposal



The completely emptied spray cans must be disposed of in the recycling system. Cans with hardened material must be disposed of as special waste.

### Note

For professional use only.  
Identification, see safety data sheet.

The contents in this technical data sheet were created with great care and reflect our current state of knowledge. They provide the user with application-specific information and do not promise certain properties. The information is non-binding and we accept no liability for its integrity, accuracy and completeness. They do not relieve the user of their duty to check the suitability of our product for the intended purpose. The warnings printed on our labels must be respected. Our brands and patents are protected by copyright. All rights reserved We reserve the right to update, amend or supplement the content of the information without prior notice.