

Peter Kwasny GmbH, Heilbronner Str. 96  
74831 Gundelsheim / Deutschland  
Telefon: +496269 95-0, Fax: +496269 95-80  
www.spraymax.com / www.kwasny.com / info@kwasny.de

## SprayMax® 2K 2 IN 1 HEADLIGHT CLEAR Art. Nr. 684068



### Product

#### Description / Purpose

Special 2K clear coat for renewal or repair of the protective coating of polycarbonate lenses. Highly transparent, light-fast and weatherresistant clear coat. Increases resistance to environmental influences (UV light, salt water, car wash, etc.) and protects against new damages.

#### Properties

- Special product for the preparation of headlights coated with clear lacquer
- Increases protection against new damage
- Protects against yellowing

#### Material base

Two-component acrylic resins  
Activator: aliphatic isocyanates

#### Colour

Transparent

#### Gloss level

gloss

#### VOC Value (EU)

92 + / -4 gloss units at 20° measuring angle  
627 g/l

### Substrate

#### Surface preparation

#### Step by step pre-treatment of the headlights:

- 1.) Check whether headlight removal is possible
  - 1.1 if yes, mask the back of the headlight
  - 1.2 if no, mask complete area around the headlight



2.) Clean the surface of the headlight with  
SprayMax Silicone Remover

3.) Sanding

Completely sand the headlight

3.1 Clearcoat Preparation

3.1.1 Step mechanically wet or dry sanding  
with P 1000

3.1.2 Step mechanically wet or dry sanding  
with P 2000

Clean surface between the sanding steps with  
SprayMax Aqua-Silicon Remover 680094.

3.2. Clearcoat Repair

3.2.1 Step mechanically dry sanding P 180

3.2.2 Step mechanically dry sanding P 320  
(with soft pad)

3.2.3 Step mechanically dry sanding P 500  
(with soft pad)

3.2.4 Step mechanically dry sanding P 800  
(with soft pad)

3.2.5 Step mechanically wet or dry sanding  
with P 1000

3.2.6 Step mechanically wet or dry sanding  
with P 2000

Clean surface between the sanding steps with  
SprayMax Aqua-Silicon Remover 680094.

4.) Clean surface with SprayMax Aqua-Silicone  
Remover 680094

5.) Control

Check surface for potential sanding marks.

Make sure it is equally sanded and transparent

6.) Clean surface with a wipe immediately before  
painting

## Processing

### Protection measures



Wear personal protection equipment.  
(respiratory mask/gloves/goggles)  
For more information, see safety data sheet.

### Shake

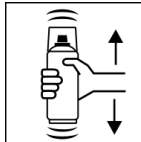

Before activating, shake can thoroughly for 2 minutes from when the mixing balls are heard.

### Place red button

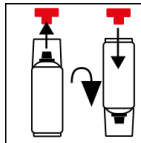

Remove the red button from the cap. Turn the can by 180° and fit the button onto the pin.

### Press red button

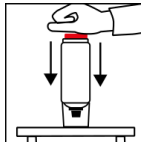

Turn the can upside down and place on a firm surface. Press the red button with the palm of your hand until it clicks into place.

### Shake

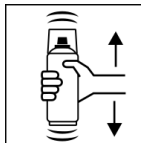

After activating, shake can again thoroughly for 2 minutes, again from when the mixing balls are heard.

### Spray to test

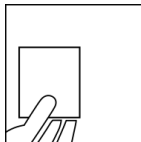

After shaking the can, test spray and check compatibility with the surface and the colour.

### Spraying distance

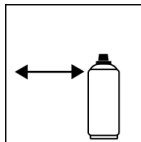

15 cm - 20 cm

### Spray passes

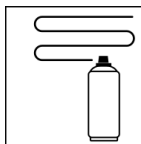

Dry film thickness 40 µm (approx. 2 spray coats)  
Apply a thin, film building spray coat, flash off and apply again another film building spray coat to achieve a smooth surface.

### Flash-off time

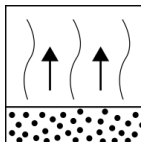

Flash time:  
approx. 10 min between each spray coat

### Processing conditions

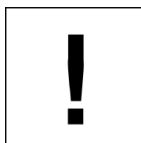

Optimum application at 18° C - 25° C and a relative humidity from 40 - 60 %.

## Drying

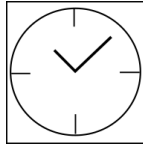

TG1 dust dry: 15 - 20 min

TG3 dry to touch: 3 h

TG5 Ready for polishing: over night

The stated values refer to the above mentioned processing conditions. The level of dryness is determined pursuant to DIN 53150.



IR- drying possible,

Observe equipment description

10 min end flash off; after

25 - 30 min at 60° C object temperatur

## Continue

Can be polished over night at room temperature or 30 min at 60° C.

## Pot life

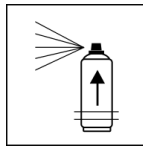

Approx. 8 h at 20 °C room temperature and a relative humidity of approx. 40 - 50 %. The processing time depends on the ambient temperature.

Higher temperatures reduce the pot life, lower temperatures will prolong it.

## Finish

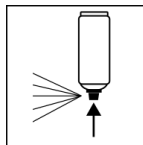

After painting, turn the can upside down and spray the valve until empty.

## Additional Information

### Shelf Life

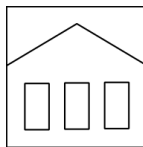

36 months (not activated)

The usage period refers to an unused can that is stored correctly at a temperature of 15 - 25° C and a relative humidity below 60%. The can must be stored and transported in an upright position in a dry place where it is protected against chemical and mechanical influences. The safety information on the can and all statutory provisions applicable for the storage site must be observed.

### Disposal



The completely emptied spray cans must be disposed of in the recycling system. Cans with hardened material must be disposed of as special waste.

**Note**

For professional use only.

Identification, see safety data sheet.

The contents in this technical data sheet were created with great care and reflect our current state of knowledge. They provide the user with application-specific information and do not promise certain properties. The information is non-binding and we accept no liability for its integrity, accuracy and completeness. They do not relieve the user of their duty to check the suitability of our product for the intended purpose. The warnings printed on our labels must be respected. Our brands and patents are protected by copyright. All rights reserved We reserve the right to update, amend or supplement the content of the information without prior notice.