

Technical Data Sheet



The United States of America:
by Peter Kwasny Inc.
62-64 Enter Lane
Islandia, NY 11749

Distributed in

Canada:
Peter Kwasny Spraypaint Canada Inc.
40 University Avenue, Suite 904
Toronto, ON. M5J 1T1

Toll free North America
Phone: 1-844-426-6330 / Fax: 1-866-226-6434
order@kwasny.us / service@kwasny.us
www.spraymax.com

SprayMax® 2K Hot Rod Black Satin 341 g NET WT. 12 oz Art. Nr. 3680212



Product

Description / Purpose

For small damage repair jobs on existing semi gloss Hot Rod Black parts/surfaces or for an easy and fast paint job of a new or restored parts.

Properties

- Easy to use
- High quality two component coating
- Very good flow
- Highest chemical and weather resistance
- Long lasting and very durable finish

Material base

Base: special acrylic resins
Activator: Aliphatic polyisocyanates

Colour

Black

Gloss level

40 gloss units at 60° measuring angle

Solid content

approx. 43 % by weight relating to the diluted paint

EPA Coating Category

NFP Non Flat Coating

PWR Limit 1.40

CARB Aerosol Rule Coating Category (01/2017)

TCC Two Component Coating

PWR Limit 1.20

Substrate

Metal, Steel, Stainless Steel (cleaned and sanded)
Depending on the surface select the appropriate
Primer to achieve maximum adhesion and corrosion
protection.

Aluminum (cleaned and sanded)

SMC, Fiberglass

All plastics used in the automotive industries like
ABS and PP/EPDM. To achieve maximum adhesion
it is recommended to clean the surface thoroughly
and apply SprayMax 1K Plastic Adhesion Promoter
3680009. Do not use on Polyethylene (PE).

Wood (cleaned and sanded)

Glass, Ceramics (cleaned)

The damaged area must be dry and free of grease
and dust and all rust needs to be removed.

Processing

Protection measures



Wear personal protection equipment.

(respiratory mask / gloves / goggles)

For more information, see safety data sheet.

Shake

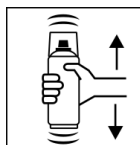

Before activating, shake can thoroughly for 2 minutes
again from when the mixing balls are heard.

Place red button

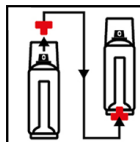

Remove the red button from the cap. Turn the can
by 180° and fit the button onto the pin.

Press red button

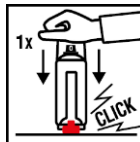

Turn the can upside down and place on a firm
surface. Press the red button with the palm of your
hand until it clicks into place.

Shake

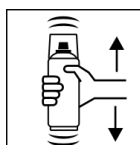

After activating, shake can again thoroughly for
2 minutes, again from when the mixing balls are
heard.

Adjustable Nozzle

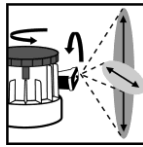

Set the variable spray nozzle to the size and pattern of the damage.

Spray to test

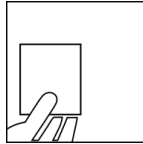

After shaking the can, test spray and check compatibility with the surface and the colour.

Spraying distance

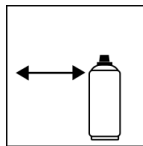

6 - 8 inches / 15 - 20 cm

Spray passes

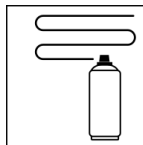

Dry film thickness 2 - 3 mil (50 - 75 µm)
(approx. 2 - 3 spray coats)

Flash-off time

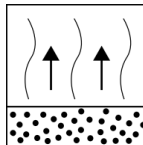

Flash time: approx. 10 min between each spray coat

Processing conditions



Optimum application at 64° F - 77° F (18° C - 25° C)
and a relative humidity from 40 - 60 %.

Drying

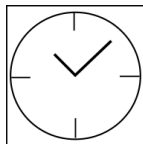

dust dry: 16 min

dry to touch: approx. 3 h

Ready for polishing: approx. 1 day

The stated values refer to the above mentioned processing conditions. The level of dryness is determined pursuant to DIN 53150.



IR drying possible,

Respect technical manual

Pot life

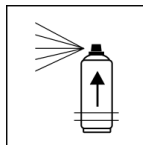

Approx. 24 h at 68° F (20° C) room temperature
and a relative humidity of approx. 40 - 50 %.

The processing time depends on the ambient temperature. Higher temperatures reduce the pot life, lower temperatures will prolong it.

Finish

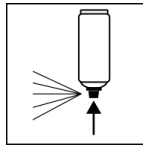

After painting, turn the can upside down and spray the valve until empty.

Additional Information

Shelf Life

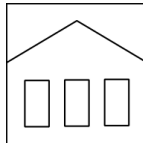

36 months (not activated)

The usage period refers to an unused can that is stored correctly at a temperature of 68° F / 20° C and a relative humidity below 60 %. The can must be stored and transported in an upright position in a dry place where it is protected against chemical and mechanical influences. The safety information on the can and all statutory provisions applicable for the storage site must be observed.

Disposal



The completely emptied spray cans must be disposed of in the recycling system. Cans with hardened material must be disposed of as special waste.

Note

For professional use only.

Identification, see safety data sheet.

The contents in this technical data sheet were created with great care and reflect our current state of knowledge. They provide the user with application-specific information and do not promise certain properties. The information is non-binding and we accept no liability for its integrity, accuracy and completeness. They do not relieve the user of their duty to check the suitability of our product for the intended purpose. The warnings printed on our labels must be respected. Our brands and patents are protected by copyright. All rights reserved. We reserve the right to update, amend or supplement the content of the information without prior notice.