



The United States of America:
Peter Kwasny Inc.
62-64 Enter Lane,
Islandia, NY 11749

Distributed in

Canada by
Peter Kwasny Spraypaint Canada Inc.
2275 Lakeshore Blvd. West, Suite 530
Toronto, ON. M8V 3Y3

Toll free North America
Phone: 1-844-426-6330 / Fax: 1-866-226-6434
order@kwasny.us / service@kwasny.us
www.spraymax.com

SprayMax®
2K FillClean® Solventborne 2K Coatings
Series H
230 g NET WT. 8.1 oz
Art. Nr. 3680088



Product

Description / Purpose

2-component spray can pre-filled with propellant, solvent and hardener for one filling of 2K solvent-based top coats using a suitable filling device. Suitable 2K topcoats: please refer to our SprayMax product brochure or our web page www.spraymax.com

Filling with a filling unit: Slightly twist and remove the spray head and fill the can with 100 ml of undiluted paint without hardener additives using the filling unit. We recommend sieving the paint before filling into the filling cap or funnel. Please observe the instructions provided by the equipment manufacturer. Replace the spray head by twisting slightly after filling. Then turn the can upside down and spray 1 - 2 times briefly. This cleans the valve and the riser and guarantees the function. Replace the cap and note the colour code and filling quantity on the can if necessary.

Filling quantity: 3.5 fl.oz /100 ml

Material base

Organic solvents

EPA Coating Category

Activator: aliphatic polyisocyanates

EFA Exact Match Finish Automotive

PWR Limit 1.50

**CARB Aerosol Rule Coating Category
(01/2017)**

TCC Two Component Coating

PWR Limit 1.20

Substrate

Primed, filled areas and well preserved factory or old paint (cleaned and sanded).

The damaged area must be dry and free of grease and dust and all rust needs to be removed.

Processing

Protection measures



Wear personal protection equipment.
(respiratory mask/gloves/goggles)

For more information, see safety data sheet.

Shake

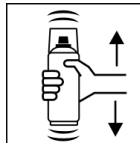

After filling with paint and before activating, shake can thoroughly for 2 minutes from when the mixing balls are heard.

Place red button

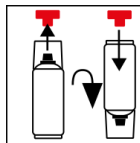

Remove the red button from the cap. Turn the can by 180° and fit the button onto the pin.

Press red button

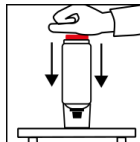

Turn the can upside down and place on a firm surface. Press the red button with the palm of your hand until it clicks into place.

Shake

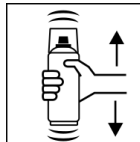

After activating, shake can again thoroughly for 2 minutes, again from when the mixing balls are heard.

Spray to test

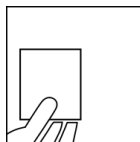

After shaking the can, test spray and check compatibility with the surface and the colour.

Spraying distance

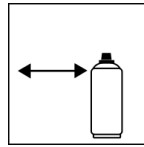

6 - 8 inches / 15 - 20 cm

Spray passes

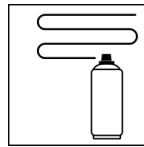

Dry film thickness 2.3 mil (60 µm)
(approx. 2 - 3 spray coats)

Flash-off time

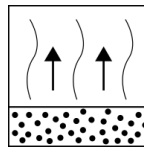

Flash time: approx. 5 min between spray coats

Processing conditions



Optimum application at 64° F - 77° F (18° C - 25° C)
and a relative humidity from 40 - 50 %.

Drying

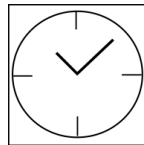

Please observe the information of the paint manufacturer.

Ready for polishing after 24 h

Continue

If necessary, polish with conventional polishes

Pot life

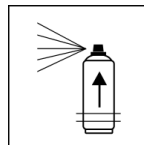

Approx. 1 day at 68° F (20° C) after activation.
The pot life depends on the ambient temperature.
Higher temperatures give a shorter and lower
temperatures give a longer pot life.

Finish

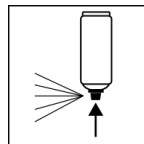

After painting, turn the can upside down and spray
the valve until empty.

Additional Information

Important Information

The use of the can filled with paint depends heavily
on the filled paint material. The information refers to
processing 2K top coats and serves as general
recommendations. Please observe the technical
information of the paint manufacturer. Do not allow

the spray can to stay for longer periods without the spray head as otherwise it may be difficult to attach the spray head. The respective FillClean cap set needs to be ordered separately for filling with the FillClean filling unit.

Shelf Life

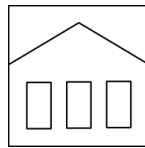

24 months (pre-gassed, not activated can that has not yet been filled with paint) The usage period refers to an unused can that is stored correctly at a temperature of 60° F - 77° F / 15 - 25° C and a relative humidity below 60%. The can must be stored and transported in an upright position in a dry place where it is protected against chemical and mechanical influences. The safety information on the can and all statutory provisions applicable for the storage site must be observed.

Disposal



The completely emptied spray cans must be disposed of in the recycling system. Cans with hardened material must be disposed of as special waste.

Note

For professional use only.
Identification, see safety data sheet.

The contents in this technical data sheet were created with great care and reflect our current state of knowledge. They provide the user with application-specific information and do not promise certain properties. The information is non-binding and we accept no liability for its integrity, accuracy and completeness. They do not relieve the user of their duty to check the suitability of our product for the intended purpose. The warnings printed on our labels must be respected. Our brands and patents are protected by copyright. All rights reserved. We reserve the right to update, amend or supplement the content of the information without prior notice.