

Technical Data Sheet



The United States of America:
by Peter Kwasny Inc.
12222 Merit Drive, #130
Dallas, TX 75251

Distributed in

Canada:
Peter Kwasny Spraypaint Canada Inc.
40 University Avenue, Suite 904
Toronto, ON. M5J 1T1

Toll free North America
Phone: 1-844-426-6330 / Fax: 1-866-226-6434
order@kwasny.us / service@kwasny.us
www.spraymax.com

SprayMax®
2K Clear Matte
318 g NET WT. 11.2 oz
Part. No. 3680065



Product

Description / Purpose

2K Clear Coat available in two gloss levels (Matt & Satin).
Developed for the Small Damage Repair Process or complete painting of mounting parts.

Properties

- Very fast drying
- Excellent levelling
- Highest chemical and weathering resistance
- Gloss units at 85°: Matt 12 ± 3 / Satin 40 ± 3

Material base

Two-component acrylic resins
Activator: aliphatic isocyanates

Gloss level

Matt,
12 ± 3 gloss units at 85° measurement angle on completely dried basecoats

Solid content

approx. 25 % by weight relating to the diluted paint

EPA/CARB Coating Category

TWC Two Component Coating
PWR Limit 1.20

Substrate

Solvent and waterborne base coat systems,
old paint coats dried according to manufacturer's
instructions (cleaned and sanded).

Do not apply over acrylic lacquer top coats!

Processing

Protection measures



Wear personal protection equipment.
(respiratory mask / gloves / goggles)

For more information, see safety data sheet.

Shake

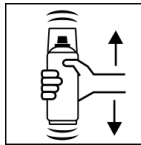

Before activating, shake can thoroughly for 2 minutes
from when the mixing balls are heard.

Place red button

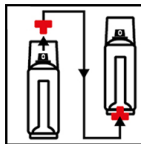

Remove the button from the cap and place it on the
pin at the base of the can. Place the can with the
button facing down, vertically on a firm, horizontal
surface.

Press red button

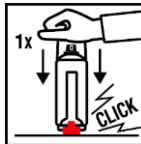

Press the can down with the heel of your hand,
applying even pressure. Listen for cracking sound.
Only press once.

Shake

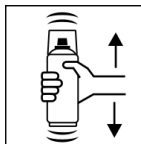

After activating the hardener, shake the spray can
again for 2 minutes, again from when the mixing balls
are heard.

Spray to test

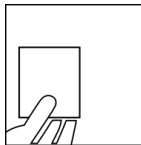

After shaking the can, test spray and check
compatibility with the surface and the colour.

Spraying distance

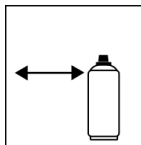

6 - 8 inches / 15 - 20 cm

Spray passes

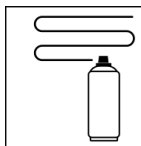

Dry film thickness 1.6 mil (40 µm)
(approx. 1 - 2 spray coats)

Flash-off time

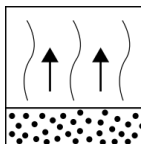

Flash time:
approx. 5 min between each spray coat

Processing conditions



Optimum application at 64° F - 77° F (18° C - 25° C) and a relative humidity from 40 - 60 %.

Coverage

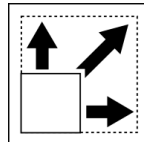

approx. 5.4 - 8.1 sq ft (0.5 - 0.75 m²) / aerosol at approx. 1.2 - 2.0 mil (30 - 50 µm) dry film thickness

Drying

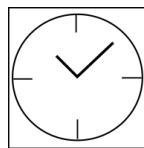

dust dry: 12 min
dry to touch: 80 min

Do not polish!

Matt clearcoats can generally not be polished - polishing changes the gloss and colour impression.



IR drying possible, Respect technical manual

Forced dry 60 min at 140° F

10 min flash-off time before forced dry

IR drying 15 min

Pot life

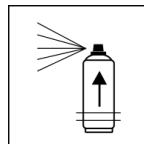

Approx. 48 h at 68° F (20° C) room temperature and a relative humidity of approx. 40 - 50 %.

The processing time depends on the ambient temperature. Higher temperatures reduce the pot life, lower temperatures will prolong it.

Finish

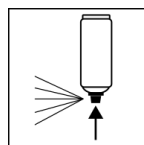

After painting, turn the can upside down and spray for 3 - 5 seconds to clean the valve.

Additional Information

Important Information



Avoid bumps, friction and impact.

Shelf Life

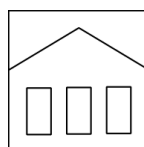

36 months (not activated)

The usage period refers to an unused can that is stored correctly at a temperature of 68° F / 20° C and a relative humidity below 60%. The can must be

stored and transported in an upright position in a dry place where it is protected against chemical and mechanical influences. The safety information on the can and all statutory provisions applicable for the storage site must be observed.

Disposal



The completely emptied spray cans must be disposed of in the recycling system. Cans with hardened material must be disposed of as special waste.

Note

For professional use only.

Identification, see safety data sheet.

The contents in this technical data sheet were created with great care and reflect our current state of knowledge. They provide the user with application-specific information and do not promise certain properties. The information is non-binding and we accept no liability for its integrity, accuracy and completeness. They do not relieve the user of their duty to check the suitability of our product for the intended purpose. The warnings printed on our labels must be respected. Our brands and patents are protected by copyright. All rights reserved. We reserve the right to update, amend or supplement the content of the information without prior notice.